



X4E2H-301

Through Shaft Clutch-Brake
Integral Double-Single Sprockets
Stop & Start the Shaft
Minimum Sprocket Size

Chain Size	40
Number Teeth	30

Clutch Engagement/Brake Engagement	Air/Spring
Facing Type	High Coefficient
Clutch Torque @ 80 PSI (max) – Dynamic	1,264 Pound Inches
Brake Torque @ Spring Pressure (fixed)	102 Pound Inches
Brake Release Pressure	20 - 25 PSI
Maximum RPM	1,750

Bore with Standard Keyway	1.000 Inches
Air Volume New	1.9 Cubic Inches
Air Volume Worn	2.57 Cubic Inches
Finish	Aluminum
Open or Enclosed Construction	Open
Shipping Weight	13 Pounds

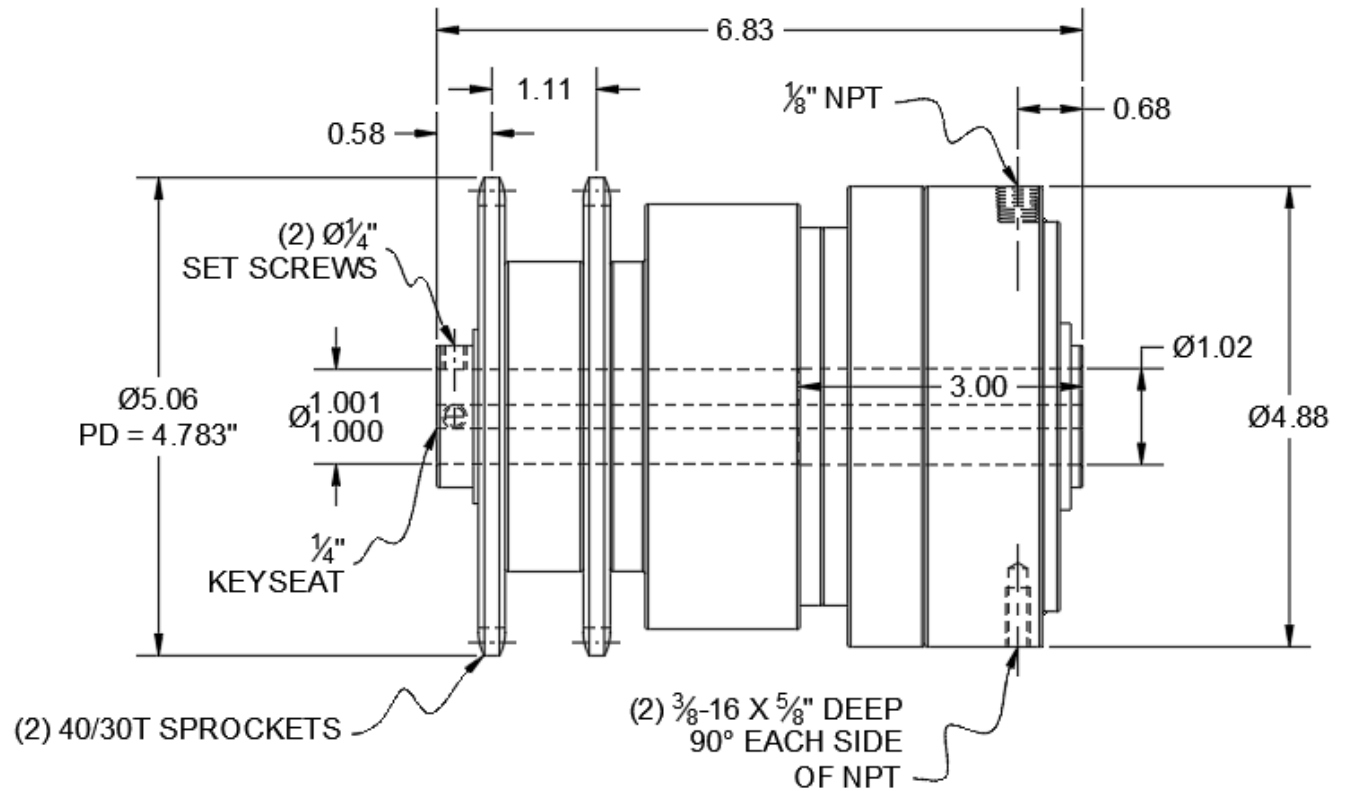

TORQUE vs. AIR PRESSURE

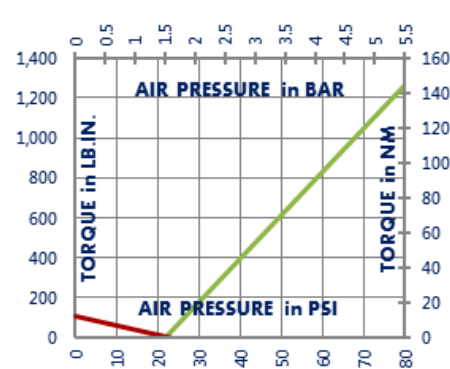

NEW vs. BURNISHED TORQUE

New clutch or brake torque is approximately 40% less than rated design torque until the friction and drive discs are worn in (lapped, burnished). The length of time for wear-in to occur varies by application.

When calculating required torque always use a service factor of 1.5 to 2. It is not recommended to select a product for use at its maximum rated torque for continuous duty.

PRODUCT SELECTION

Torque capacity is only one factor to consider when making a product selection. Insure that you will have right product for the job by contacting our engineering department for application review and selection assistance.



859-291-0849

engineering@machiii.com

www.machiii.com

X4E2H-301

Parts Diagram

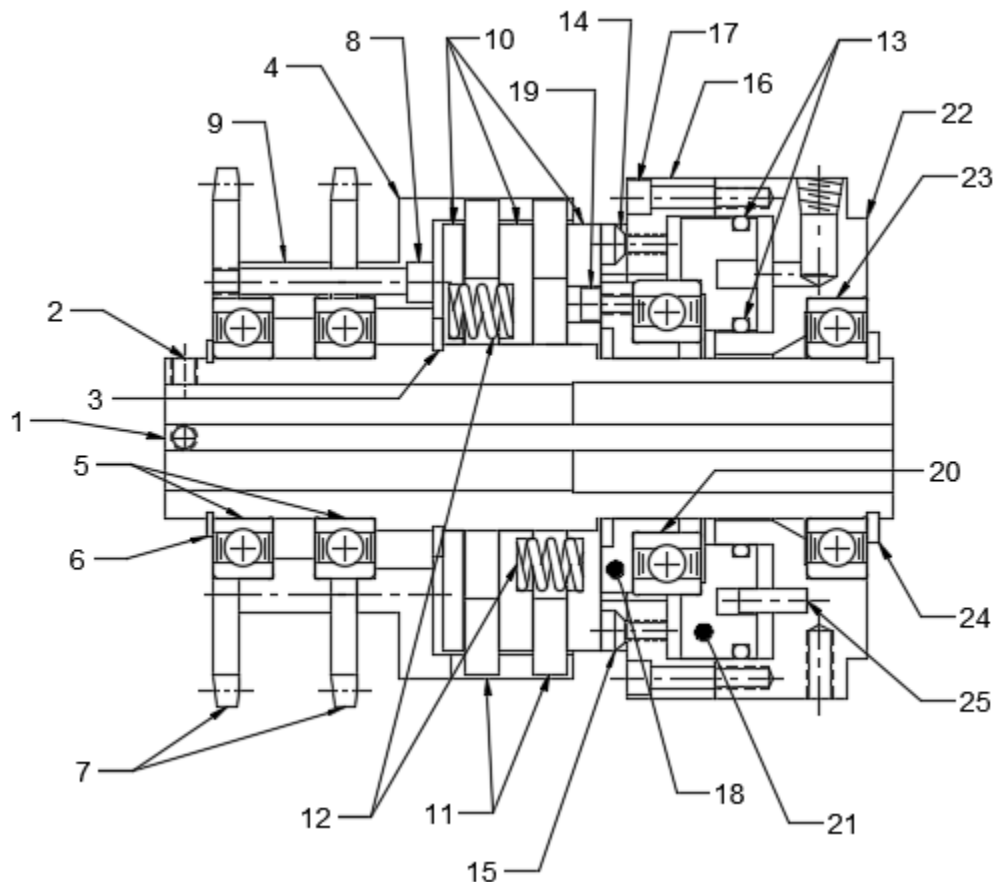

REF#	DESCRIPTION & PARTS INCLUDED	QUANTITY	KIT NUMBER
DRIVE HUB KIT			X4E2H-301-HUBK
1	Drive Hub	1	
2	Set Screw	2	
3	Retainer Ring	1	
SLEEVE KIT			X4E2H-301-SLVK
4	Sleeve	1	
5	Bearing	2	
6	Retainer Ring	1	
7	Sprocket	2	
8	Screw	3	
9	Spacer	1	
DRIVE DISC KIT			X4G2H-174-DRDK
10	Drive Disc	3	
REPAIR KIT			X4E2H-301-RPRK
11	Friction Disc	2	
12	Coil Spring	6	
13	O-Ring	2	
14	Screw	6	
16	Brake Friction Disc	1	
ADAPTER KIT			X4G2H-174-ADPK
16	Brake Adapter	1	
17	Screw	6	
PISTON KIT			X4G2H-174-PSTK
18	Cone	1	
19	Screw	1	
20	Bearing	1	
21	Piston	1	
CYLINDER KIT			X4E2H-301-CYLK
22	Cylinder	1	
23	Bearing	1	
24	Pin	2	
25	Retainer Ring	1	

PARTS KITS

The *Repair Kit* contains common wear items for this product. Users are encouraged to stock one or more repair kits considering the number of units installed and the potential downtime if machinery on which the unit is installed is critical equipment. To obtain current pricing and lead time for parts kits, contact customer service.

orders@machiii.com

ADDITIONAL PRODUCT INFORMATION

Click on the links below or copy and paste into your web browser.

To view the Installation & Maintenance Manual for this product:

http://www.machiii.com/PDF/Product-Manuals/CLUTCHBR_SHAFT_DBLSPKT_MANUAL.pdf

For information about the application and use of this and other Mach III products:

<http://machiii.com/Application/Default.asp>



859-291-0849

engineering@machiii.com

www.machiii.com